

STAYSTRAIGHTTM

Patent Protected

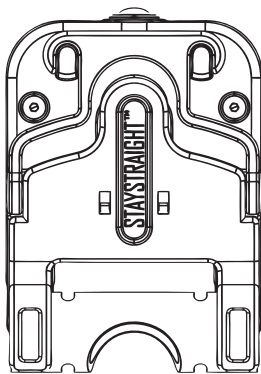

USER MANUAL

Model: Deluxe

English - Deutsch - Español
Français - Italiano



	CLASS 2 LASER PRODUCT	
---	--------------------------------------	---

Diode Laser

Max. output power: **< 1 milliwatt**
Wavelength: **400-700 nanometers** (visible light)
Min. divergence: **1 milliradian**
Output: **Continuous (CW)**
Laser hazard classification: **Class 2**

**Laser
Safety
Facts**



Laser hazards

Eye injury from beam
Do not look into the direct or reflected beam; can cause eye injury up to 25 ft (7.5 m) away.

Visual interference (glare) with pilots and drivers
Interferes with vision up to 525 ft (160 m) away. Can be a distraction up to 1 mile (1.6 km) away. **NEVER point any laser towards aircraft or vehicles; it is unsafe and illegal.**

Safe use guidance
Class 2 lasers are considered safe for accidental eye exposure. Do not look or stare into beam. Do not aim at aircraft. **This is not a toy.** Always supervise children.

Additional safety information online
Scan the QR code above, or visit LaserSafety.info/2

Manufacturer:
Marglaw Ltd (Trading As ThingsWeCre8)
63-66 Hatton Garden
London, EC1N 8LE

EN

Intellectual Property Protection

The **Staystraight Deluxe** is protected by the following Intellectual Properties with further applications pending.

PATENTS GRANTED

GB2486192

GB2540928

PATENTES PENDING

EP3405013

DESIGNS

003375500-0001

003375500-0002

003375500-0003

TRADEMARKS

STAYSTRAIGHT

1. What's included

This package includes the following items. If any items are missing or broken, please contact retailer or ThingsWeCre8.

Includes one CR2032 battery (not shown).

Go to <https://thingswecre8.com/usermanual> for additional languages.

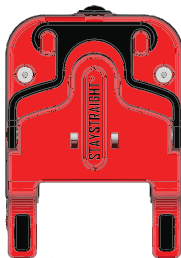

Staystraight Deluxe

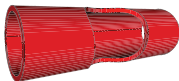

Saddle post adapter



Mini screwdriver

2. Names of parts

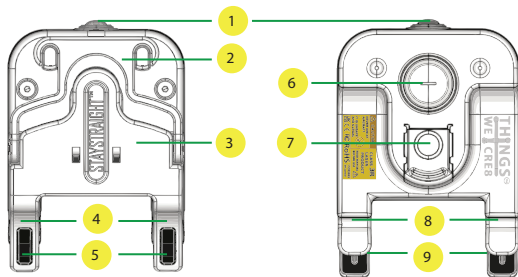

- 1 Operating Switch
- 2 Saddle Rail Hanger
- 3 Clamp Arm
- 4 Upper Clamp Jaws
- 5 Upper Clamp Jaw Pads
- 6 Laser Line Aperture
- 7 Battery Compartment Cover
- 8 Lower Clamp Jaws
- 9 Lower Clamp Jaw Pads

3. Handlebar compatibility

The **Staystraight Deluxe** is compatible with both Tapered Handlebars and Uniform Diameter Handlebars.

It fits a stem clamp diameter range of 22.2mm - 31.8mm.
This covers BMX to Oversized handlebar diameter.

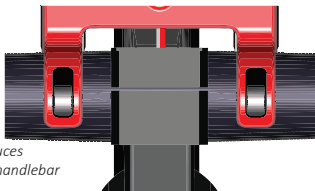

*Diameter reduces
towards the handlebar
grip.*

Tapered Handlebar. Typically found on Mountain Bikes,
Hybrid Bikes and most old bikes.

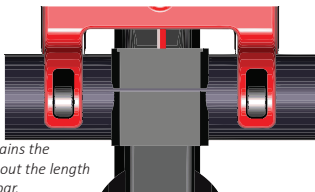

*Diameter remains the
same throughout the length
of the handlebar.*

Uniform Diameter Handlebar. Typically found on
BMX, Road Bikes and some Hybrid Bikes.

4. Stem width compatibility

The **Staystraight Deluxe** is compatible with a maximum Stem face-plate width of 50mm.

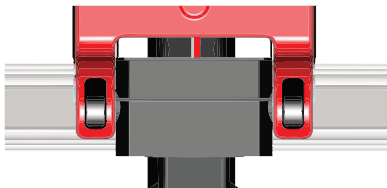

Wide Stem Face-plate. Typically found BMX bikes.

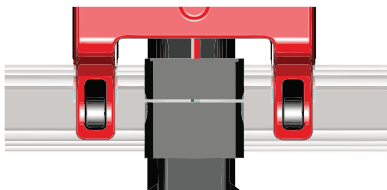

Standard width Stem Face-plate. Typically found on most bikes that are not BMX.

5. Before you start

Hold the **Staystraight Deluxe** with the Laser Line Aperture facing the floor.

Switch on the tool to ensure the projected laser line is visible.

If there is no projected line or the projection is faint, replace the CR2032 battery.

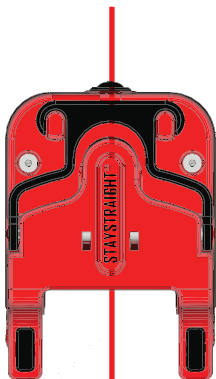

WARNING: The **Staystraight Deluxe** is a specially calibrated product with a laser component. Any attempt to repair the tool yourself will result in improper calibration, thereby rendering the tool inaccurate and of no use.

It may be dangerous and will void your warranty.

EN

6. Aligning your handlebar

Remove any obstructing cables or devices on either side of the stem faceplate.

STEP 1: Clamp the **Staystraight Deluxe** to your handlebar, with each Clamp Jaw positioned on either side of the stem.



Make sure the **Staystraight Deluxe** is parallel to the floor.
Ensure it is not tilting up or down at the front end.

STEP 2: Switch on the tool.



It is important to maintain an equal distance between the two Clamp Jaws and the sides of the Stem.

This is **CRITICAL** when using the **Staystraight Deluxe** with a Tapered Handlebar.

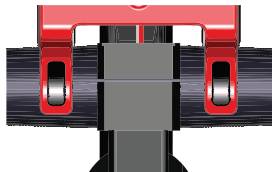

With a Uniform Diameter Handlebar, this is not so critical. However, since the **Staystraight Deluxe** is calibrated to project the line along its central plane, maintaining the equal distance as described above (and in the illustrations) means the projection falls along the central seam/plane of the tyre. (Not that it makes a difference to the alignment, but it does look cool.)

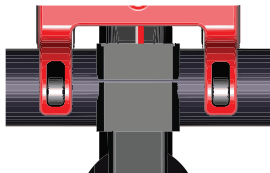

A perfectly aligned Handlebar is perpendicular to the front wheel.
That is 90°. Not 89.9°.

STEP 3: Adjust your handlebars so that the laser line is projected parallel to the central seam/plane of your tyre. **Accuracy is that easy!**

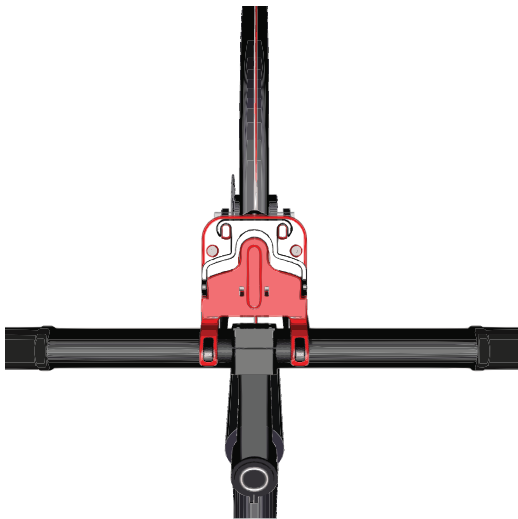

7. Aligning your saddle

The **Staystraight Deluxe** can be used to align the saddle. Saddles are mounted according to an ISO dimension between the saddle rails.

The Saddle Post Adapter and the Saddle Rail Hanger are used to achieve accurate saddle alignment.

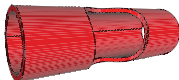

NOTE: Perform the alignment **AFTER** setting the riding height.

STEP 1: Loosen the nut that secures the saddle rail to the saddle post, enough to be able to freely move the saddle forward and backward, as if you are adjusting your reach.

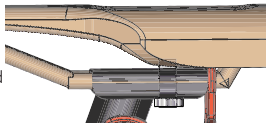

STEP 2: With the Saddle Post Adapter firmly gripped in the Clamp jaws, place the Saddle Rail Hooks on the saddle rails, ensuring the Hooks are flat against the saddle post clamp.

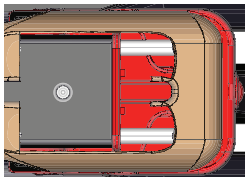

This ensures the unit is fixed in place without any movement.

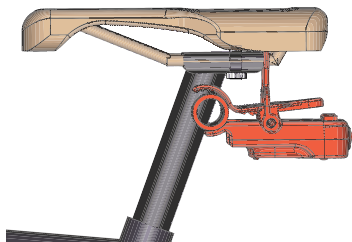

Similar to when using the **Staystraight Deluxe** to align your handlebar, ensure the tool is parallel to the floor AND the Saddle Rail Hanger is extended at a **right angle**.

The Saddle Post Adapter has **two different diameters** at either side of the cut-out. Rotating the Saddle Post Adapter allows it to adapt to the diameter of the saddle post. This improves stabilization.

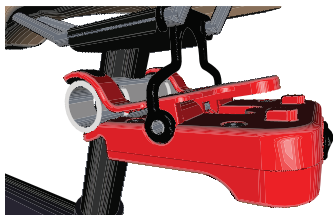

EN

STEP 3: Switch on the **Staystraight Deluxe** and adjust the saddle by rotating gently from side to side, **making sure not to alter** the riding height.

The saddle is accurately aligned when the projected laser line runs along the central seam/plane of the rear tyre.



8. BMX Handlebar warp detection

EN

The **Staystraight Deluxe** is additionally useful for warp detection. This is a typical concern for BMX riders.

STEP 1: To detect warp in your handlebar, clamp the **Staystraight Deluxe** to the bottom tube of the handlebar and align your handlebar to the front tyre as normal.

Secure the handlebar stem to stop any rotation.

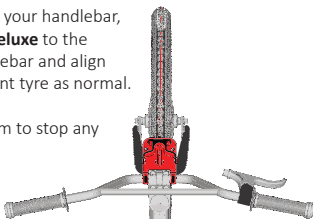

STEP 2: Clamp the **Staystraight Deluxe** to the protector bar on the handlebar.

If there is no warp in the handlebar, the laser line **should still be aligned** parallel to the central plane of the front tyre.

If the laser line is not parallel, there is warp in the handlebar.

(The illustration has a warp in the handlebar tilting the left forward)

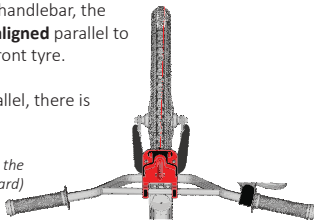

9. Changing the battery

The **Staystraight Deluxe** comes with a mini screwdriver with a flat tip.

This is supplied for the sole purpose of clicking-out the battery from the battery holder.

STEP 1: Remove the Battery Compartment Cover and insert the flat tip of the screwdriver in the gap as shown in the illustration.

STEP 2: Gently pry out the battery.

STEP 3: Replace the battery, paying attention to the positive and negative placement.



10. Care and troubleshooting

EN

CAUTION: The **Staystraight Deluxe** IS NOT A TOY.
It is a tool carefully calibrated during manufacture.

You can view the **Calibration Certification** by going to <https://thingswecre8.com/serial>. Enter your Product Serial Number and you can view the calibration pictures of your product.

Points to Remember:

1. Care should be taken when using and generally handling the tool.
2. Dropping the tool may affect the accuracy of the unit.
3. If you suspect the accuracy of your **Staystraight Deluxe** is compromised, please do not attempt to repair it yourself.
Once the tool has been tampered with, the warranty will be void.
4. When the tool is not in use, make sure it is switched off.
This prolongs the battery life and avoids accidental damages.
5. It is recommended to keep the tool in the packaging when not in use.
6. The tool contains a laser module. Use in strict adherence to regulations at all time. **Do not look into the beam or aim at planes or cause any form of distraction or potential harm to you and others.**





THINGS[®]
WE!CRE8

Marglaw Ltd. (Trading As ThingsWeCre8)
63-66 Hatton Garden
London, EC1N 8LE
<https://thingswecre8.com>
cs@thingswecre8.com